

REVISIONS			
REV.	DESCRIPTION	DATE	BY

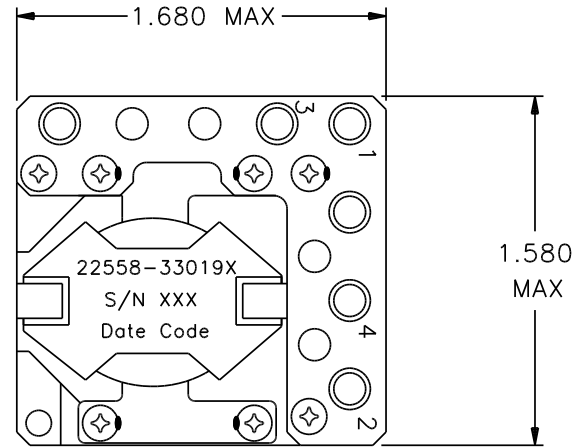
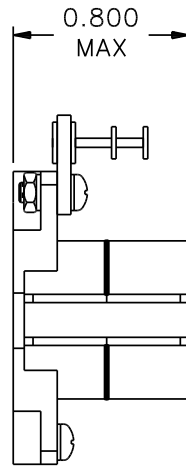

Classification

MIL-PRF-27 Grade: 6
 MIL-PRF-27 Class: S (130° C)
 Maximum Ambient Temperature: 105° C

MIL-STD-981 Quality Assurance Provisions

Class	Description	Drawing Number ¹
C	Commercial Parts	33019-30
B	Group A Inspection	33019-31B
E	Group A Inspection	33019-31S
S	Group A Inspection	33019-31S and
	Group B Inspection	33019-85

¹ The germane data will ship with the hardware.

LOAD CONDITIONS		
Terminals	IDC A	P = I ² R W
1 - 2	6.248	0.219
3 - 4	6.248	0.187
P _{TOTAL} = 0.406 W		

Electrical Characteristics

DC Resistance: (1 - 2) = 5.6 mΩ
 (Maximum) (3 - 4) = 4.8 mΩ

Ratio and Polarity: (Ratios are verified with un-gapped core prior to assembly)
 3 - 4/1 - 2 = 1.000 Nominal

Inductance (measured at 0.1V, 10 KHz):
 L_o (1 - 2) = 13.5 μH ± 10% IDC = 0
 (1 - 2) = L_o - 10%, IDC = 6.248 A

These Parts Are Manufactured in Strict Compliance to MIL-STD-981.

The "X" in the part number refers to the Quality Level (C, B, E or S), see Quality Assurance Provisions above.	UNLESS OTHERWISE SPECIFIED: Dimensions are in inches, and tolerances are:		COAST/ACM		
	Fractions	Decimals	Angles	TITLE Coupled Inductor	
	±1/64	.X = ±0.1 .XX = ±0.03 .XXX = ±0.010	±1/2°	FSCM 22558	DWG. NO 33019X
DO NOT SCALE DRAWING	DRAWN BY Jim Allen	DATE 08/14/03	SCALE: none	MAX. WT.: 65 grams	SHEET 1 OF 1