

REVISIONS			
REV.	DESCRIPTION	DATE	BY

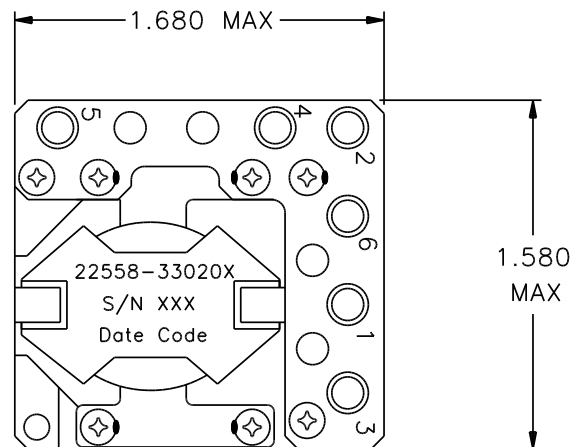
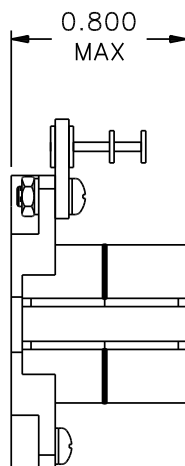

Classification

MIL-PRF-27 Grade: 6
 MIL-PRF-27 Class: S (130° C)
 Maximum Ambient Temperature: 105° C

MIL-STD-981 Quality Assurance Provisions

Class	Description	Drawing Number ¹
C	Commercial Parts	33020-30
B	Group A Inspection	33020-31B
E	Group A Inspection	33020-31S
S	Group A Inspection	33020-31S and Group B Inspection 33020-85

¹ The germane data will ship with the hardware.

LOAD CONDITIONS		
Terminals	I _{DC} A	P = I ² R W
1 - 2	4.15	0.144
3 - 4	4.15	0.167
5 - 6	0.05	0.000
		P _{TOTAL} = 0.311 W

Electrical Characteristics

DC Resistance: (1 - 2) = 8.4 mΩ
 (Maximum) (3 - 4) = 9.7 mΩ
 (5 - 6) = 23 mΩ

Ratio and Polarity: (Ratios are verified with un-gapped core prior to assembly)

1 - 2/5 - 6 = 1.00 Nominal
 3 - 4/5 - 6 = 1.00 Nominal

Inductance (measured at 0.1V, 10 KHz):

L_o (1 - 2) = 20.3 μH ± 10% I_{DC} = 0
 (1 - 2) = L_o - 10%, I_{DC} = 4.15 A

These Parts Are Manufactured in Strict Compliance to MIL-STD-981.

The "X" in the part number refers to the Quality Level (C, B, E or S), see Quality Assurance Provisions above.	UNLESS OTHERWISE SPECIFIED: Dimensions are in inches, and tolerances are:		COAST/ACM		
	Fractions	Decimals	Angles	TITLE	
	±1/64	.X = ±0.1 .XX = ±0.03 .XXX = ±0.010	±1/2°	Coupled Inductor	
	DRAWN BY	DATE	FSCM	DWG. NO	REV.
DO NOT SCALE DRAWING	Jim Allen	08/12/03	22558	33020X	
		SCALE: none	MAX. WT.: 65 grams	SHEET 1 OF 1	