

REVISIONS			
REV.	DESCRIPTION	DATE	BY

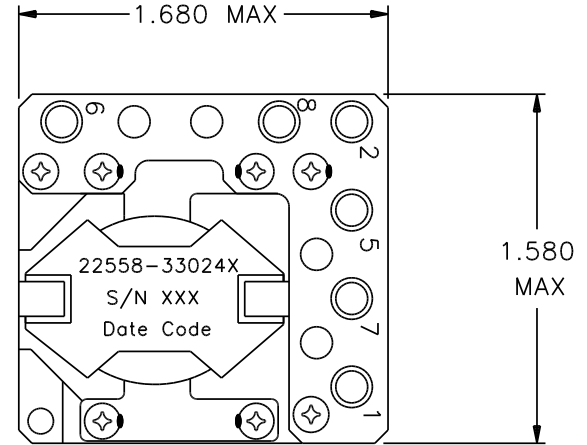
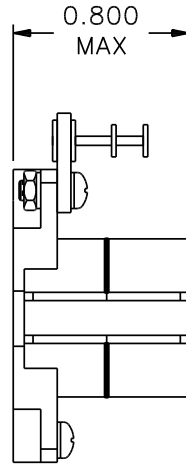

Classification

MIL-PRF-27 Grade: 6
 MIL-PRF-27 Class: S (130° C)
 Maximum Ambient Temperature: 105° C

MIL-STD-981 Quality Assurance Provisions

Class	Description	Drawing Number ¹
C	Commercial Parts	33024-30
B	Group A Inspection	33024-31B
E	Group A Inspection	33024-31S
S	Group A Inspection	33024-31S and
	Group B Inspection	33024-85

¹ The germane data will ship with the hardware.

LOAD CONDITIONS		
Terminals	IDC A	P = I ² R W
1 - 2	4.545	0.043
3 - 4	0.934	0.003
5 - 6	1.214	0.004
P _{TOTAL} = 0.050 W		

Electrical Characteristics

DC Resistance: (1 - 2) = 2.1 mΩ
 (Maximum) (5 - 6) = 2.9 mΩ
 (7 - 8) = 2.8 mΩ

Ratio and Polarity: (Ratios are verified with un-gapped core prior to assembly)

5 - 6/1 - 2 = 0.750 Nominal
 7 - 8/1 - 2 = 0.750 Nominal

Inductance (measured at 0.1V, 10 KHz):

Lo (1 - 2) = 11.2 μH ± 10% IDC = 0
 (1 - 2) = Lo - 10% Minimum, IDC = 6.2A

These Parts Are Manufactured in Strict Compliance to MIL-STD-981.

The "X" in the part number refers to the Quality Level (C, B, E or S), see Quality Assurance Provisions above.	UNLESS OTHERWISE SPECIFIED: Dimensions are in inches, and tolerances are:		COAST/ACM		
	Fractions	Decimals	Angles	TITLE	
	±1/64	.X = ±0.1 .XX = ±0.03 .XXX = ±0.010	±1/2°	Coupled Inductor	
	DRAWN BY	DATE	FSCM	DWG. NO	REV.
DO NOT SCALE DRAWING	Jim Allen	08/12/03	22558	33024X	
		SCALE: none	MAX. WT.: 65 grams	SHEET 1 OF 1	