

REVISIONS			
REV.	DESCRIPTION	DATE	BY

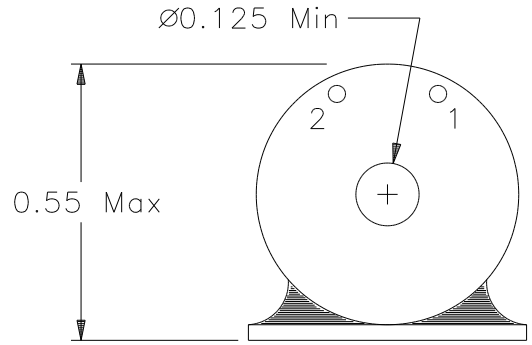
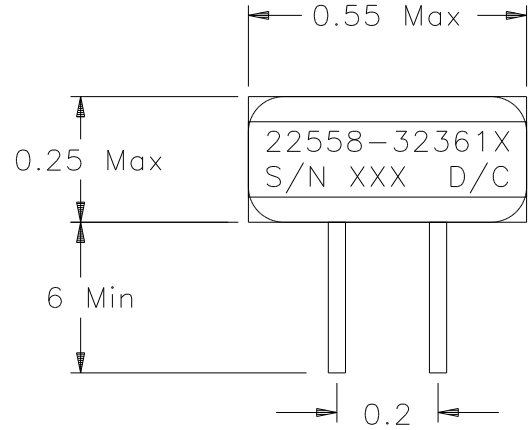

Classification

MIL-PRF-27 Grade: 6
 MIL-PRF-27 Class: S (130° C)
 Maximum Ambient Temperature: 105° C

MIL-STD-981 Quality Assurance Provisions

Class	Description	Drawing Number ¹
C	Commercial Parts	32361-30
B	Group A Inspection	32361-31B
E	Group A Inspection	32361-31S
S	Group A Inspection	32361-31S and
	Group B Inspection	32361-85

¹ The germane data will ship with the hardware.

Maximum Operating Load Conditions
 E(1 - 2) = 2 V, 250kHz
 P_{TOTAL} < 0.8 W

Electrical Characteristics

DC Resistance (1 - 2) = 4.7 Ω Maximum

Volt-Seconds (1 - 2) = 400 μV-Sec. Minimum, @ 40mA ± 10%, 10kHz Sqr. Wave, R_s = 20Ω

Ratio and Polarity (3 - 4/1 - 2) = 0.00400 ± 0.00003 (Note: 3 - 4 is 1 turn test winding with the Start on the Lead side of the Transformer)

These Parts Are Manufactured in Strict Compliance to MIL-STD-981.

The "X" in the part number refers to the Quality Level (C, B, E or S), see Quality Assurance Provisions above.	UNLESS OTHERWISE SPECIFIED: Dimensions are in inches, and tolerances are:		COAST/ACM		
	Fractions	Decimals	Angles	TITLE	
	±1/64	.X = ±0.1 .XX = ±0.03 .XXX = ±0.010	±1/2°	Current Sense Transformer	
	DRAWN BY	DATE	FSCM	DWG. NO	REV.
	Jim Allen	03/26/03	22558	32361X	
DO NOT SCALE DRAWING			SCALE: none	MAX. WT.: 3 grams	SHEET 1 OF 1