

REVISIONS			
REV.	DESCRIPTION	DATE	BY

Leads are self leads 6" minimum long.

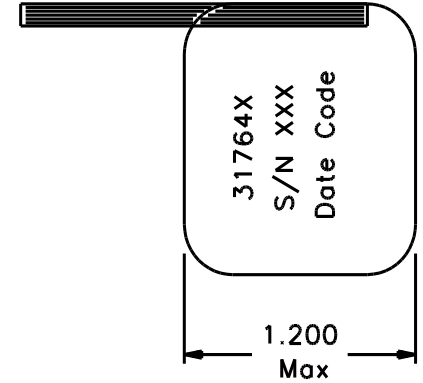
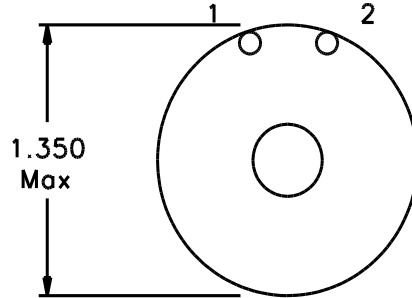

Classification

MIL-PRF-27 Grade: 6
 MIL-PRF-27 Class: S (130° C)
 Maximum Ambient Temperature: 105° C

MIL-STD-981 Quality Assurance Provisions

Class	Description	Drawing Number ¹
C	Commercial Parts	31764-30
B	Group A Inspection	31764-31B
E	Group A Inspection	31764-31S
S	Group A Inspection	31764-31S and
	Group B Inspection	31764-85

¹ The germane data will ship with the hardware.

<u>LOAD CONDITIONS</u>	
IDC = 14A	P _{TOTAL} = 1.2 W

Electrical Characteristics

DC Resistance: (1 - 2) = 6.0 mΩ Maximum

Inductance (measured at 0.1V, 10 KHz):
 (1 - 2) = 24 μH Minimum @ IDC = 14A

These Parts Are Manufactured in Strict Compliance to MIL-STD-981.

The "X" in the part number refers to the Quality Level (C, B, E or S), see Quality Assurance Provisions above.	UNLESS OTHERWISE SPECIFIED: Dimensions are in inches, and tolerances are:		COAST/ACM		
	Fractions ±1/64	Decimals .X = ±0.1 .XX = ±0.03 .XXX = ±0.010	Angles ±1/2°	TITLE Inductor	
	DRAWN BY Jim Allen	DATE 05/12/03	FSCM 22558	DWG. NO 31764X	REV.
DO NOT SCALE DRAWING			SCALE: none	MAX. WT.: 81 grams	SHEET 1 OF 1